

# Shenzhen LANTAI Technology Co., Ltd

## TS30 Specification

### Wireless Car Charger

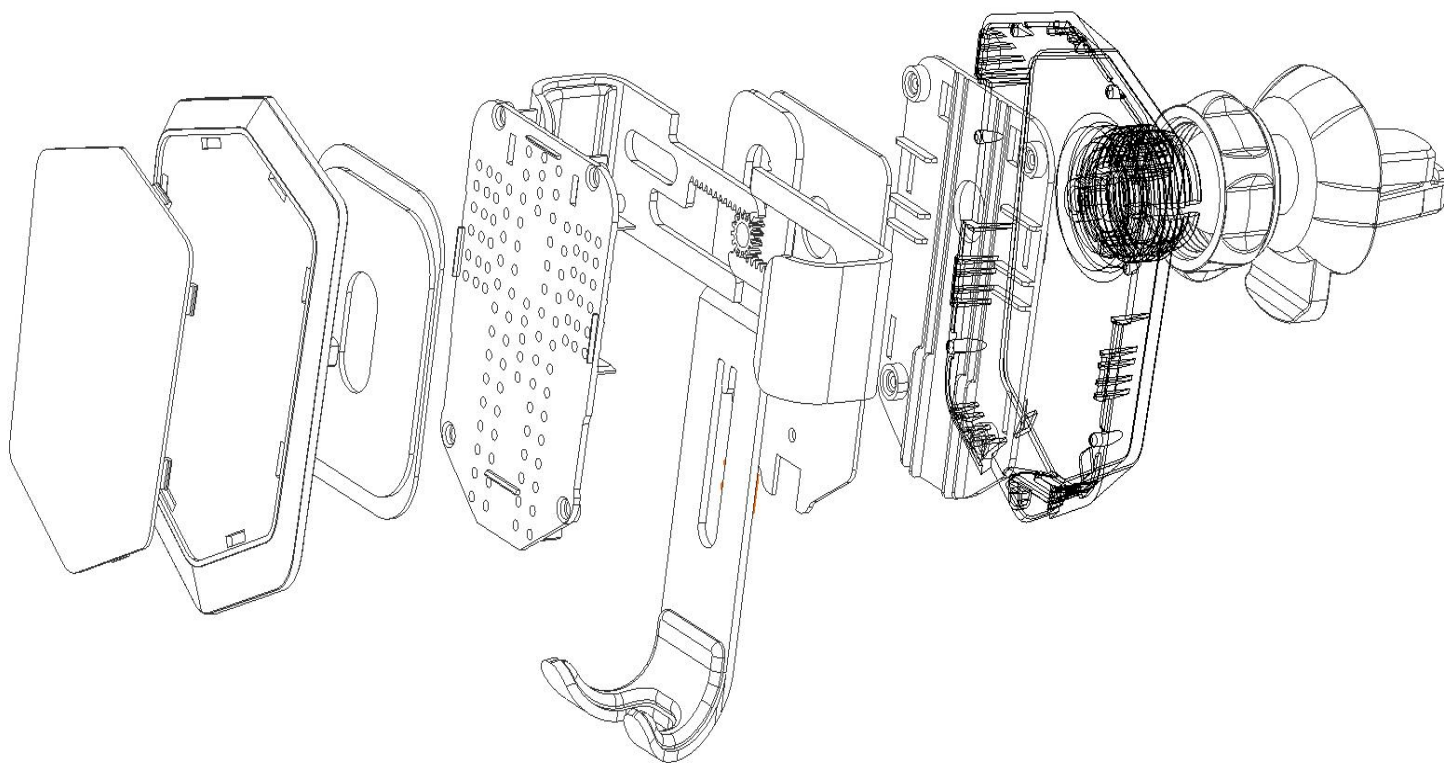

# Shenzhen LANTAI Technology Co., Ltd

## TS30 Specification

### 1. Product Introduction

TS30 is a vehicle-mounted wireless fast charging transmitter. The wireless transmission scheme of TS01 is compatible and conforms to the Qi standard. It supports wireless fast charging, which can realize the quickly charging of wireless charging equipment. Simple and generous design, easy to operate, to ensure a good experience of wireless charging.

### 2. Transmission Specification

Item	Specification
Charge standard	Qi-BPP/ Samsung quick charge
Input	DC 5V-2A, DC 9V-1.67A
Input voltage	5V/9V
Interface	Type-C USB (Support QC2.0 above)
Max. Output watt	10W
Static power consumption	<0.2W
Charging distance	5-8mm
Charge conversion rate	≥ 80%
Charging area	20mm*10mm
Supported device	1 pc
Certificate	CE/FCC/RoHS
Coil type	A11 Coil module
Coil quantity	1 pc
Product size	116*96*90mm
Protection function	Over-current, over-voltage, over temperature, shortcut,FOD

# Shenzhen LANTAI Technology Co., Ltd

## TS30 Specification

### 3. Adapter Specification

Input Voltage: 100Vac –240Vac  
Output Voltage: 5V±5%/9V±5  
Rated current: 2.0A  
Input frequency: 47Hz –63Hz  
Standby power consumption: < 0.3W

### 4. Work and Storage Condition

Work temperature: -10 to +60°C  
Storage temperature: -20 to +70°C

### 5. Material

ABS+PC(LG engineering level fire-proof insulation)+UV protective paint RoHS